

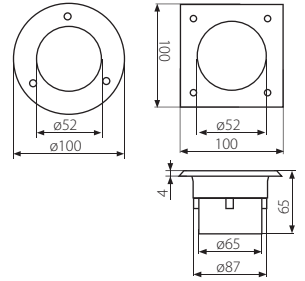

GORDO LED14 SMD-O



GORDO LED14 SMD-L



GORDO LED14 SMD-O GORDO LED14 SMD-L



- ▶ casing, front panel: stainless steel / protective pane: tempered glass
- ▶ Gehäuse, Frontpanel: Edelstahl / Schutzscheibe: stofffestes Schutzglas

Kanlux	Kanlux		[g]
GORDO LED14 SMD-O	22050	stainless steel / Edelstahl	390
GORDO LED14 SMD-L	22051	stainless steel / Edelstahl	450

220-240V	50/60Hz	0,7	14 LED SMD	6200-6600		Ra ≥70	20000 [h]		
3x1mm ² 30 cm	IP 66	IK 10	2000 kg 20 [kN]	-25÷35		1/6/36			

Kanlux

A+ A A B C D E